



Face Drivers FDNC

with drive heads and movable center pin

Face drivers for clamping workpieces **for milling** free from backlash for gear hobbing, keyway milling and other surfaces.

Type FDNC with flange retainer

Type FDNC complete with changeable parts



NEIDLEIN face drivers FDNC ensure:

- machining free from backlash due to fixed driving elements
- stability and mounting of high transverse thrust using adjustable, spring-loaded center pins
- constant datum point on the end face of the workpiece
- adjustment of dissimilar bore holes
- adjustment true at drive head for high true running accuracy
- tapered design for optimum tool path

Clamping principle

The workpiece is pushed by the tailstock force against the moving center pin, which moves back until the workpiece face side is in contact with the drive head.

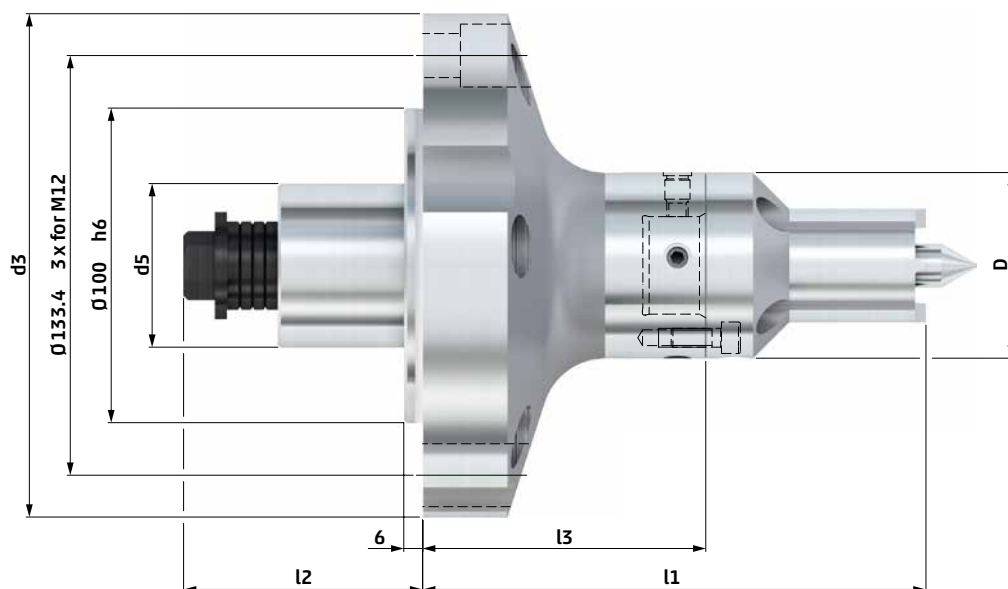
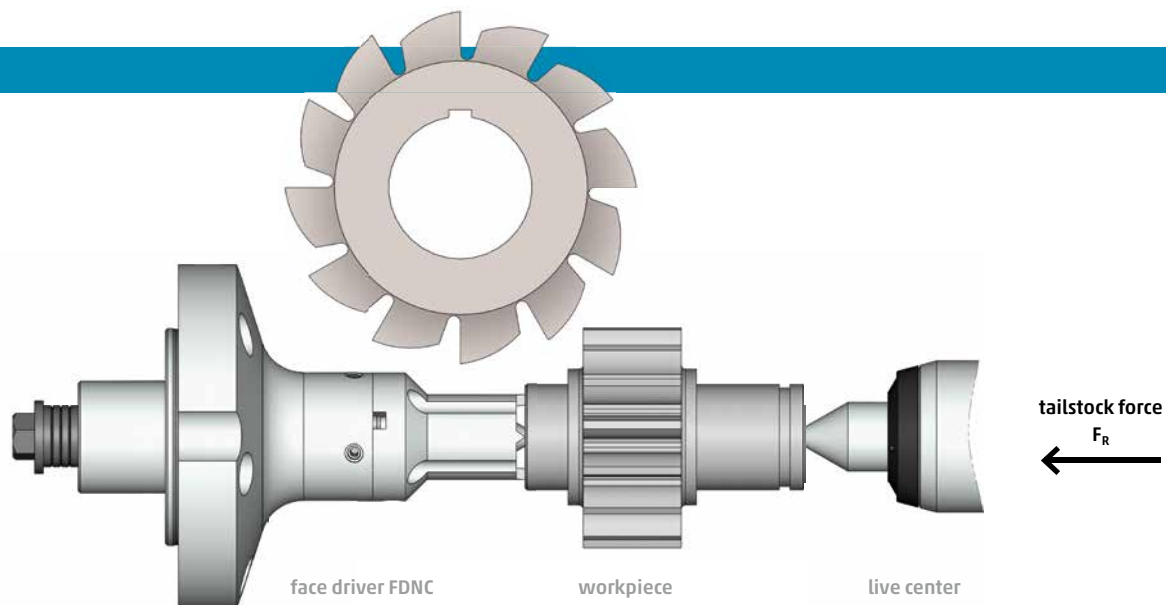

type	D	d3	d5	l1	l2	l3	cat. no.
FDNC							
11-4	59	160	52	160	77	90	732 01

■ Mounting elements for face drivers see page 68 - 73.



Drive Heads FDNC

changeable drive heads for basic body FDNC

Type FDNC · drive head



Technical data – type FDNC · drive head

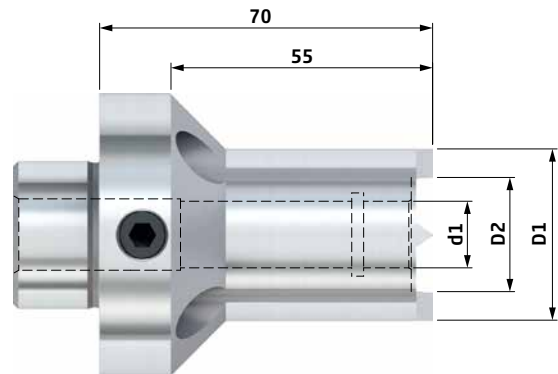

for type FDNC	D1	D2	d1	cat. no.
11.11	11	7	6	737 01
11.14	14	9	6	737 02
11.18	18	12	6	737 03
1.22	22	14	8	737 04
1.26	26	18	8	737 05
2.30	30	20	14	737 06
2.36	36	24	14	737 07
3.39	39	29	18	737 08
3.44	44	34	18	737 09
4.49	49	39	24	737 10
4.59	59	49	24	737 11

■ Additional dimensions for drive heads upon request.

Center Pins FDNC

**changeable center pins for basic body
and drive heads FDNC**

Type FDNC · center pin



Technical data – type FDNC · center pin

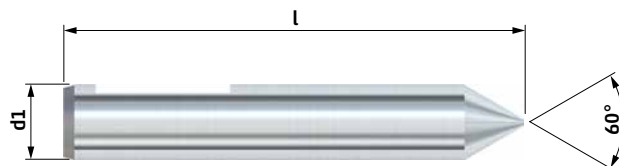

for type FDNC	d1	l	center Ø	cat. no.
11	6	78	1 - 6	733 01
1	8	80	1 - 8	733 02
2	14	86	1 - 14	733 03
3	18	89	3 - 18	733 04
4.1	24	89	3 - 18	733 05
4.2	24	96	16 - 24	733 06

■ Further center pins for other center holes upon request.