

Reducing Sleeves RH

for reducing of morse cone retainers

The reducing sleeve is used for mounting of face driver type SB, pipe driver type NDG or of various center pins with morse taper shank. Demounting by means of extraction screw thread.

Type RH with morse taper



Technical data - type RH with morse taper

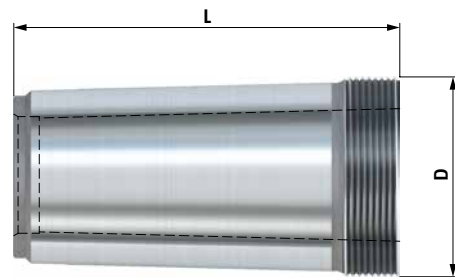

type	MK	MK	D	L	cat. no.
RF	outside	inside	screw thread		
4/3	4	3	M35 x 1.5	82	932 09
5/3	5	3	M48 x 1.5	91	932 10
5/4	5	4	M48 x 1.5	91	932 11
6/3	6	3	M70 x 1.5	128	932 12
6/4	6	4	M70 x 1.5	128	932 13
6/5	6	5	M70 x 1.5	128	932 14

■ Other sizes and special sleeves are available upon request.

Clamping principle

For retaining a morse cone shank which is smaller than the available tailstock quill or machine tool spindle, a reducing sleeve with matching size is adapted.

For easy removal the reducing sleeves are made with an extraction thread.

Type RH with morse taper

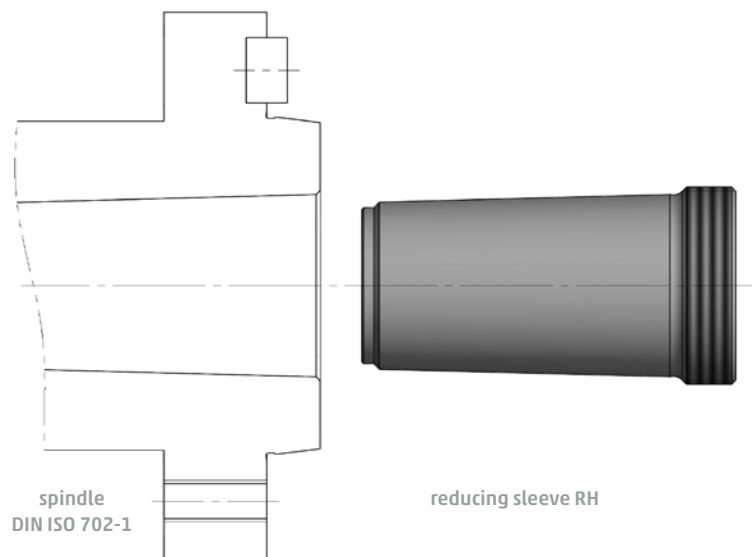

Extracting nut DIN 1804 h · for reducing sleeve RH

Type DIN 1804 h



Technical data - type DIN 1804 h

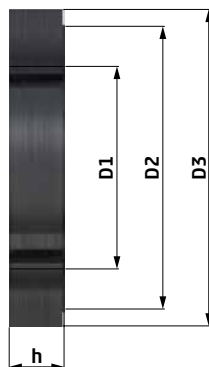

D1	D2	D3	h	cat. no.
M35 x 1.5	47	55	11	830 41
M48 x 1.5	67	75	13	830 43
M70 x 1.5	90	100	14	830 44