

## Ultra Live Centers RNA



### high flexibility at large workpiece center holes

NEIDLEIN ultra live centers type RNA are designed for employment in **turning, grinding and other production machines**.

#### Type RNA with morse taper

high degree of flexibility for clamping of workpieces with large centers



**0.01**

incl. center cone



changeable center cone  
see page 114

#### NEIDLEIN revolving ultra live centers type RNA ensure:

- application of live centers in case of high thrust and loading
- run-out deviation max.: 0.01 mm incl. center cone
- easy exchange of center cones using SK30 short taper interface and cylinder screw
- maintenance-free, due to gasket system and life-time lubrication of bearings; gasket system comprising variable seal and steel comprehensive protection cover
- excellent demounting by means of extracting nut and extracting disk, which ensures safe and easy removal of the live center from the tailstock spindle sleeve

#### TYPE TURNING

- with contact-free labyrinth seal

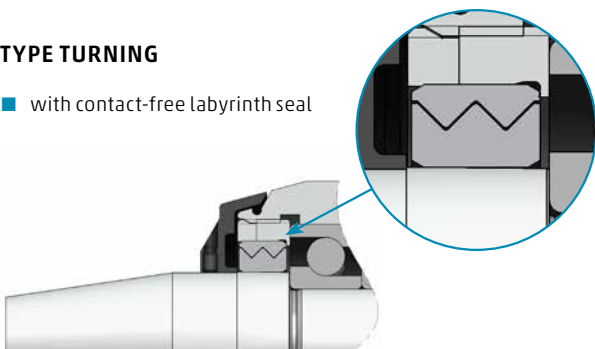

#### TYPE GRINDING

- with contact spindle seal

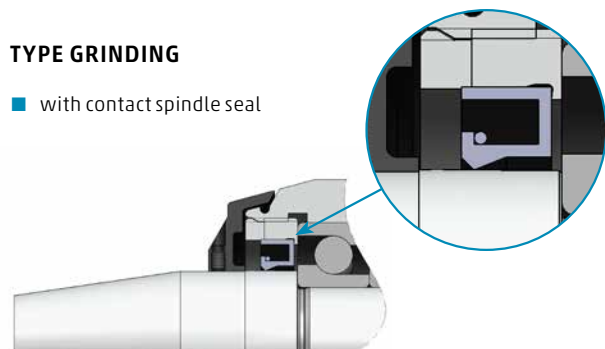

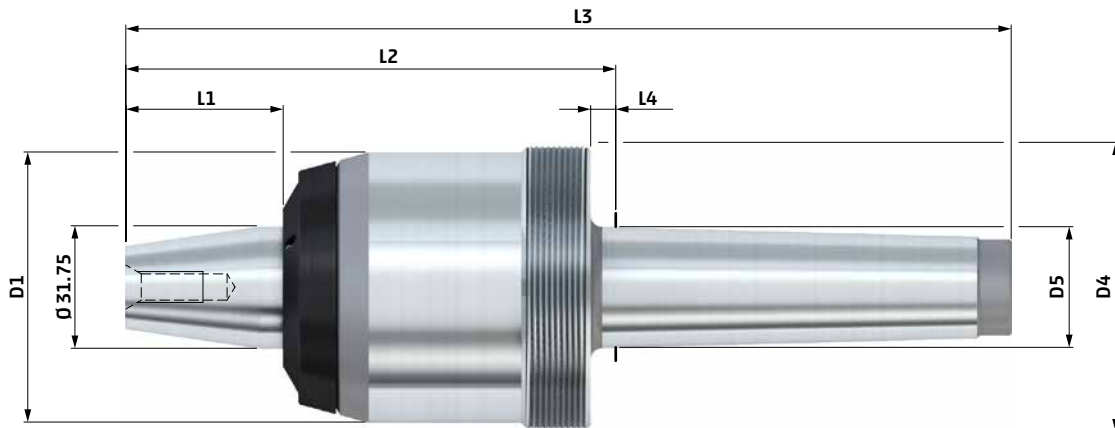
**Technical data - type RNA with morse taper**

type RNA	MK	D1	D4	D5	L1	L2	L3	L4	rpm max. [1/min]	TYPE	TYPE
										TURNING	GRINDING
										cat. no.	cat. no.
4	4	70	M75 x 1.5	31.27	41	127	229.5	6.5	7000	<b>814 04</b>	<b>814 0402</b>
	5	70	M75 x 1.5	44.4	41	127	256.5	6.5	7000	<b>814 05</b>	<b>814 0502</b>
5	5	92	M95 x 2	44.4	41	137.2	266.7	6.5	5000	<b>814 06</b>	<b>814 0602</b>
	6	92	M95 x 2	63.35	41	138.7	320.7	8	5000	<b>814 07</b>	<b>814 0702</b>
6	6	107	M110 x 2	63.35	41	150.7	332.7	8	3000	<b>814 08</b>	<b>814 0802</b>

- Run-out deviation max.: 0.01 mm incl. center cone.
- Variety of center cones ranging from Ø 25 to Ø 315, see page 114.
- Special cones up to Ø 400 available upon customer's request.
- Extracting nuts and extracting disks see page 118 - 119 for accessories.
- Speed-dependent load see page 102.

## Ultra Live Centers RNW



### high flexibility by using different changable inserts

NEIDLEIN ultra live centers type RNW are designed for employment **in turning, grinding and other production machines.**

#### Type RNW with morse taper

the adaptation of various changeable inserts ensures a high degree of flexibility and saving of costs

 **0.01**  
incl. insert



changeable inserts  
see page 116 - 117

#### NEIDLEIN revolving ultra live centers type RNW ensure:

- application of live centers in case of high thrust and loading
- run-out deviation max.: 0.01 mm incl. insert
- easy exchange of changeable inserts using spanner flat and open-end wrench or Tommy bar
- maintenance-free, due to gasket system and life-time lubrication of bearings; gasket system comprising variable seal and steel comprehensive protection cover
- excellent demounting by means of extracting nut and extracting disk, which ensures safe and easy removal of the live center from the tailstock spindle sleeve

#### TYPE TURNING

- with contact-free labyrinth seal

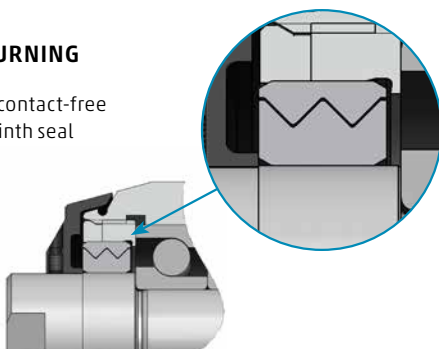

#### TYPE GRINDING

- with contact spindle seal

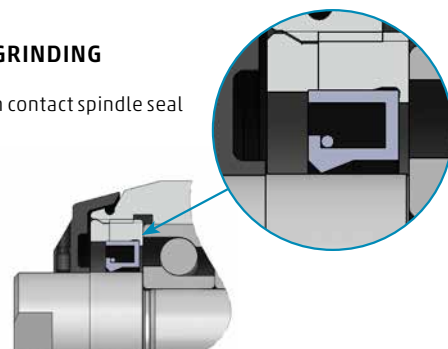

**Technical data - type RNW with morse taper**

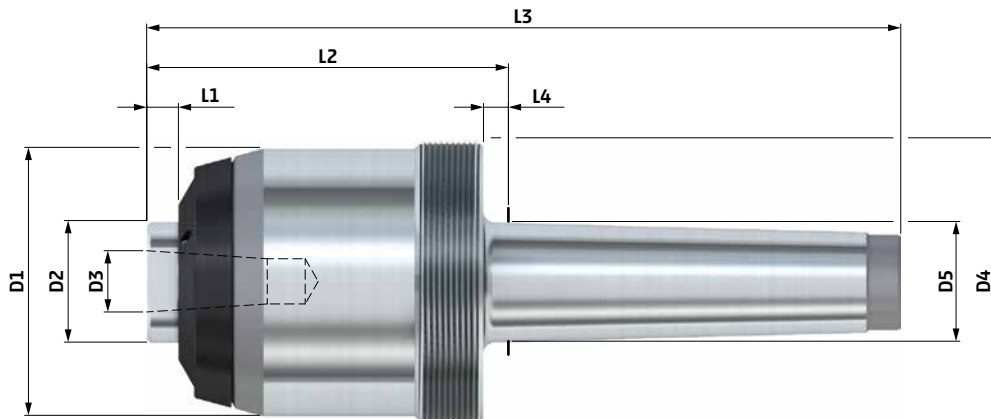

type RNW	MK	D1	D2	D3	D4	D5	L1	L2	L3	L4	rpm max. [1/min]	TYPE	TYPE
												TURNING	GRINDING
												cat. no.	cat. no.
3	3	55	22	16	M58 x 1.5	23.83	6.3	82	163	5	8000	815 01	815 0102
	4	55	22	16	M58 x 1.5	31.27	6.3	83.5	186	6.5	8000	815 02	815 0202
	5	55	22	16	M58 x 1.5	44.4	6.3	83.5	213	6.5	8000	815 03	815 0302
4	4	70	32	16	M75 x 1.5	31.27	8.3	94.5	197	6.5	7000	815 04	815 0402
	5	70	32	16	M75 x 1.5	44.4	8.3	94.5	224	6.5	7000	815 05	815 0502
5	5	92	45	22	M95 x 2	44.4	10.3	106.5	236	6.5	5000	815 06	815 0602
	6	92	45	22	M95 x 2	63.35	10.3	108	290	8	5000	815 07	815 0702
6	6	107	55	22	M110 x 2	63.35	10.3	120	302	8	3000	815 08	815 0802

- Run-out deviation max.: 0.01 mm incl. insert.
- Various changeable inserts of different designs, see page 116 - 117.
- Special inserts available upon customer's request.
- Extracting nuts and extracting disks see page 118 - 119 for accessories.
- Speed-dependent load see page 102.

## Changeable Center Cones for type RNA / FNA

### center cones for large workpiece centers

High degree of flexibility for clamping of workpieces with large centers.

For type RNA / FNA with SK30 interface



Technical data - for type RNA / FNA with SK30 interface

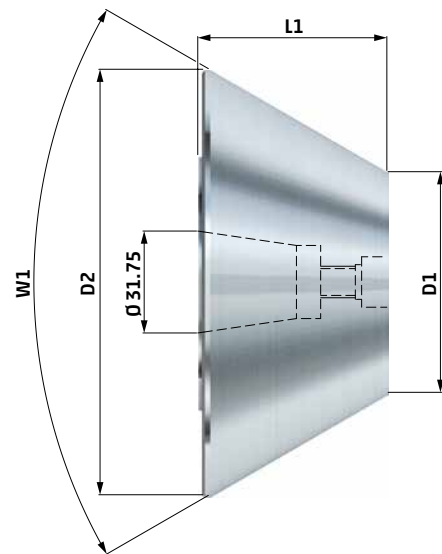

- Suitable for live centers type RNA on page 86 - 87 and for dead centers type FNA on page 108 - 109.
- Special cones up to  $\varnothing$  400 available upon customer's request.
- The center cones are fastened with a screw M8 DIN 912 onto the base body.
- The center cones can be drawn off with a screw M10.

#### FOR TYPE RNA / FNA

W1	D1	D2	L	cat. no.
60	20	85	60	<b>814 50</b>
60	70	135	60	<b>814 51</b>
60	120	185	60	<b>814 52</b>
60	170	235	60	<b>814 53</b>
60	220	285	60	<b>814 54</b>
75	20	105	60	<b>814 55</b>
75	90	175	60	<b>814 56</b>
75	160	245	60	<b>814 57</b>
75	230	315	60	<b>814 58</b>
90	20	130	60	<b>814 59</b>
90	100	210	60	<b>814 60</b>
90	180	290	60	<b>814 61</b>

## Changeable Inserts for type RNW / FNW

### Changeable inserts for a maximum of flexibility

The adaptation of various changeable inserts ensures a high degree of flexibility and saving of costs.

#### For type RNW / FNW with taper interface

model B



model G



- Suitable for live centers type RNW on page 90 - 91 and for the dead centers type FNW on page 108 - 109.
- Special inserts available upon customer's request.
- For quick demounting all changeable inserts come with spanner flat or cross hole.

#### FOR TYPE RNW3 / 4 FNW MK3 / MK4

model	D1	D2	D3	D4	L	cat. no.
<b>A</b>	22	-	-	16	30	<b>815 50</b>
<b>B</b>	22	10	-	16	40	<b>815 51</b>
<b>C</b>	22	7	10	16	30	<b>815 52</b>
<b>D</b>	22	11	-	16	30	<b>815 53</b>
<b>E</b>	55	21	-	16	35	<b>815 54</b>
<b>F</b>	55	50	10	16	30	<b>815 55</b>
<b>G</b>	22	10	-	16	40	<b>815 56</b>

#### FOR TYPE RNW5 / 6 FNW MK5 / MK6

model	D1	D2	D3	D4	L	cat. no.
<b>A</b>	34	-	-	22	35	<b>815 60</b>
<b>B</b>	34	16	-	22	45	<b>815 61</b>
<b>C</b>	34	10	7	22	29	<b>815 62</b>
<b>D</b>	34	18	-	22	35	<b>815 63</b>
<b>E</b>	70	33	-	22	38	<b>815 64</b>
<b>F</b>	70	64	24	22	34	<b>815 65</b>
<b>G</b>	34	16	-	22	45	<b>815 66</b>

**Technical data - for type RNW / FNW with taper interface**

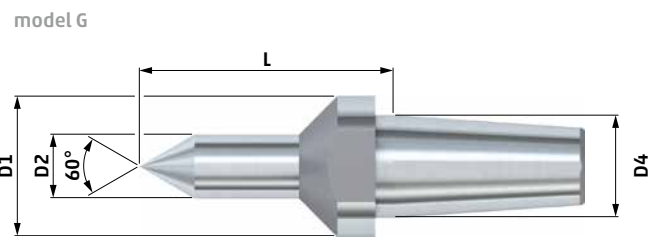
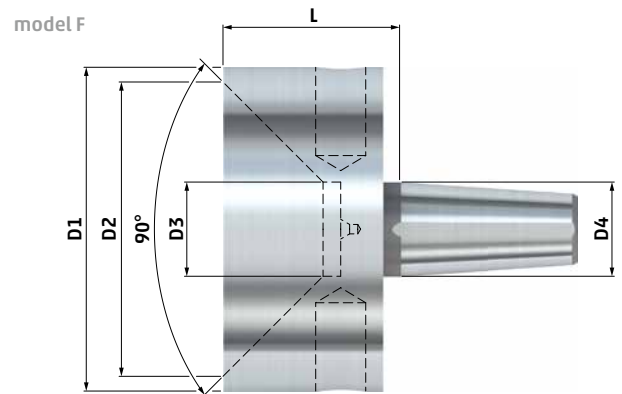
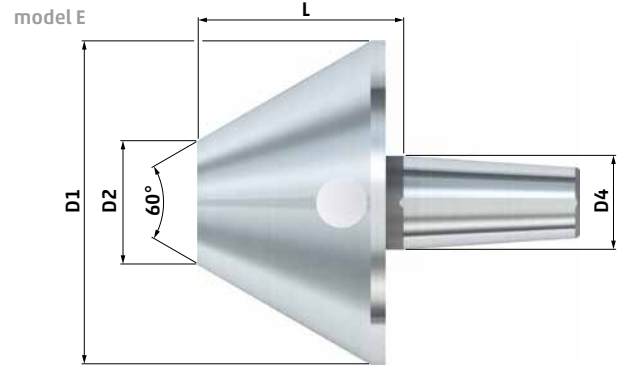
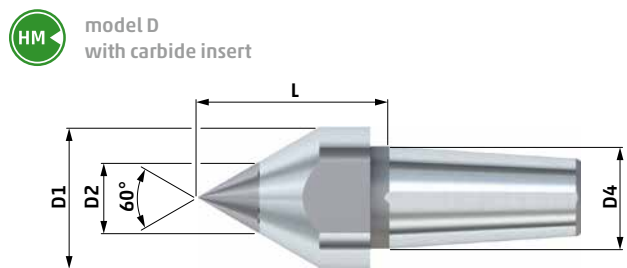
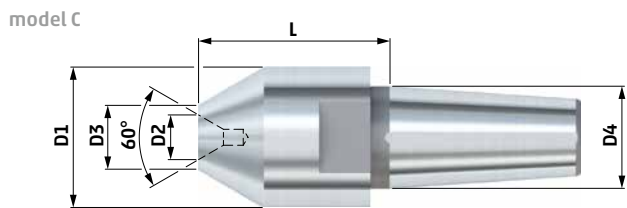
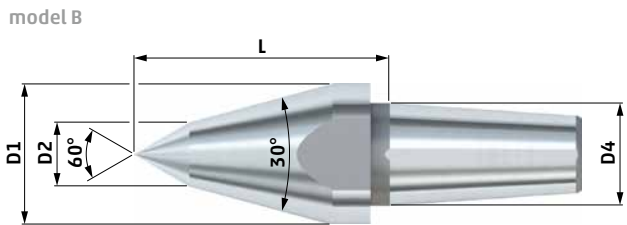
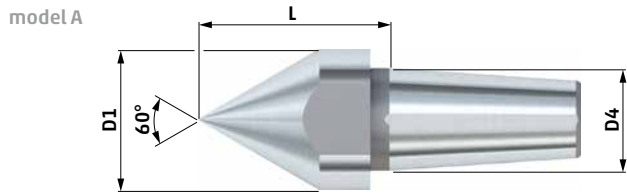

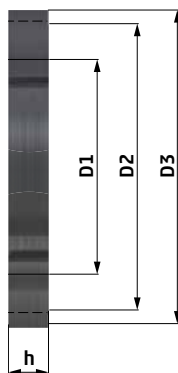
**Extracting nut DIN 1804 h****Type DIN 1804 h****Technical data - type DIN 1804 h**

for ultra live centers, center pins and face driver

D1	D2	D3	h	cat. no.
M28 x 1.5	43	50	10	<b>830 39</b>
M32 x 1.5	45	52	11	<b>830 40</b>
M35 x 1.5	47	55	11	<b>830 41</b>
M36 x 1.5	48	55	11	<b>830 42</b>
M48 x 1.5	67	75	13	<b>830 43</b>

D1	D2	D3	h	cat. no.
M58 x 1.5	80	90	13	<b>830 22</b>
M70 x 1.5	90	100	14	<b>830 44</b>
M75 x 1.5	100	110	14	<b>830 23</b>
M95 x 2	120	135	16	<b>830 24</b>
M110 x 2	140	155	16	<b>830 25</b>